

Self sealing socket+Thru-type plug



Features

NT20 series Japanese type quick couplings can be interchanged with NITTO 20, 30, 40 series, Parker-Rectus 13, CEJN315 series. Compatible with all NITTO 20 series nipples or plugs. The body, sleeve and nipples are usually made of carbon steel with chrome-plated, and the element is made of brass. It is equipped with 6 stainless steel locking balls.

The couplers are mainly divided into four types: female thread, male thread, hose barb tail and nut-lock type. The internal double sealing structure ensures the air tightness without any leakage. This series of coupling adopts a push-to-connect structure, which can be operated with one hand. NT20 series coupling has a large flow rate, is very convenient, safe and reliable. The maximum working pressure is 2.0MPa. At present, it is available for 1/4" body size only. If needs larger flow rate, we can also provide the NT30 and NT40 series.

Ordering code

NT 20 - SF - 02 B

- ◆ Japanese self-locking
- ◆ Body size
20: 1/4"
- ◆ Coupling type
SF: Female socket
SM: Male socket
SH: Hose barb socket
SN: Nut lock socket
PF: Female plug
PM: Male plug
PH: Hose barb plug
PN: Nut lock plug
- ◆ Thread code
02: 1/4"BSP
03: 3/8"BSP
04: 1/2"BSP
- ◆ Material code
B: Brass
S: Carbon steel
SS: Stainless steel SUS304/303

Specification

Series	NT20
Body Size(in.)	1/4"
Rated Pressure(MPa)	2.0MPa
Temperature Range	-10°C ~ +70°C
Locking Device	6 balls

Performance

Air NT20 Series (1/4"body size)

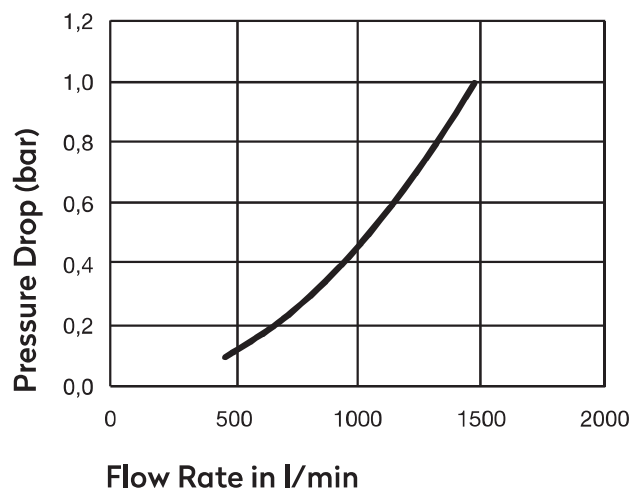

Plug profile

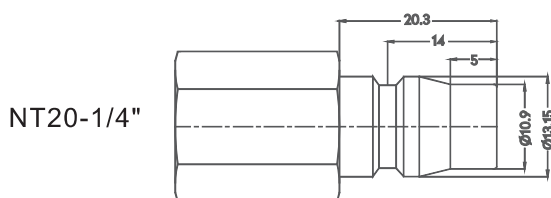

Compatible with

FOKCA	NT20
PARKER-RECTUS	13
NITTO	20,30,40
CEJN	315

NT Series Japanese Type Push-to-connect Quickc Coupling

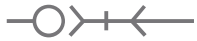
 Self sealing socket+Thru-type plug

Sockets/Couplers

Female Pipe Thread

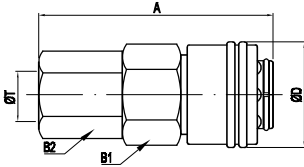

Model	Body Size	Thread -T	Overall (A)	Hex Size (B1)	Hex Size (B2)	Diameter (D)
NT20-SF-02	1/4	1/4"NPT	59	19	22	26.5
NT20-SF-03	1/4	3/8"NPT	59	19	22	26.5
NT20-SF-04	1/4	1/2"NPT	60	24	22	26.5

Male Pipe Thread

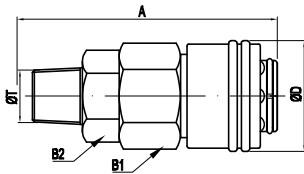

Model	Body Size	Thread -T	Overall (A)	Hex Size (B1)	Hex Size (B2)	Diameter (D)
NT20-SM-02	1/4	1/4"NPT	58.7	19	22	26.5
NT20-SM-03	1/4	3/8"NPT	58.7	19	22	26.5
NT20-SM-04	1/4	1/2"NPT	60	22	22	26.5

Standard Hose Barb

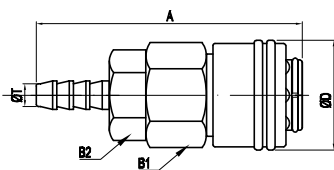

Model	Body Size	Hose I.D.	Overall (A)	Hex Size (B1)	Hex Size (B2)	Diameter (D)
NT20-SH-1/4	1/4	1/4"	72.5	19	22	26.5
NT20-SH-3/8	1/4	3/8"	73	19	22	26.5
NT20-SH-1/2	1/4	1/2"	76	19	22	26.5

Push-Lok Hose barb

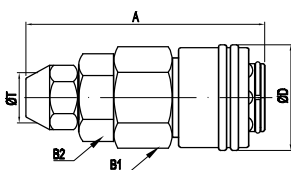

Model	Body Size	Hose I.D.	Overall (A)	Hex Size (B1)	Hex Size (B2)	Diameter (D)
NT20-SN-1/4	1/4	1/4"	62.5	19	22	26.5
NT20-SN-3/8	1/4	3/8"	62.5	19	22	26.5
NT20-SN-1/2	1/4	1/2"	66	19	22	26.5

Plugs/Nipples

Female Pipe Thread

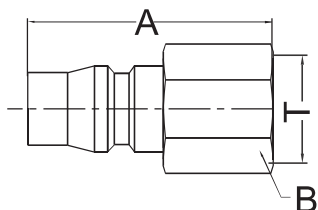

Model	Body Size	Thread -T	Overall (A)	Hex Size (B)	Diameter (D)
NT20-PF-02	1/4	1/4"NPT	36	16	
NT20-PF-03	1/4	3/8"NPT	38	19	
NT20-PF-04	1/4	1/2"NPT	46	24	

Male Pipe Thread

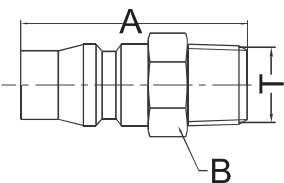

Model	Body Size	Thread -T	Overall (A)	Hex Size (B)	Diameter (D)
NT20-PM-02	1/4	1/4"NPT	39	14	
NT20-PM-03	1/4	3/8"NPT	40	17	
NT20-PM-04	1/4	1/2"NPT	51	21	

Standard Hose Barb

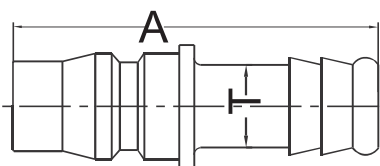

Model	Body Size	Hose I.D.	Overall (A)	Hex Size (B)	Diameter (D)
NT20-PH-1/4	1/4	1/4"	55		15
NT20-PH-3/8	1/4	3/8"	55		15
NT20-PH-1/2	1/4	1/2"	57		15

Push-Lok Hose barb

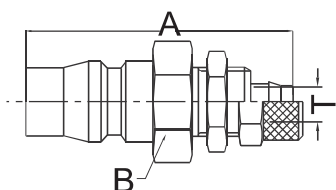

Model	Body Size	Hose I.D.	Overall (A)	Hex Size (B)	Diameter (D)
NT20-PN-1/4	1/4	1/4"	48	14	
NT20-PN-3/8	1/4	3/8"	48	17	
NT20-PN-1/2	1/4	1/2"	52	21	