

# IK Series New Milton American Type Quick Coupling

 Self sealing socket+Thru-type plug



## Ordering code

**IK 20 - SF - 02 B**

- ◆ IK New Milton series
- ◆ Body size  
20: 1/4"
- ◆ Coupling type  
SF: Female socket  
SM: Male socket  
SH: Hose barb socket  
SN: Nut lock socket  
PF: Female plug  
PM: Male plug  
PH: Hose barb plug  
PN: Nut lock plug
- ◆ Thread code  
02: 1/4"NPT  
03: 3/8"NPT  
04: 1/2"NPT
- ◆ Material code  
B: Brass  
S: Carbon steel  
SS: Stainless steel SUS304/303

## Plug profile

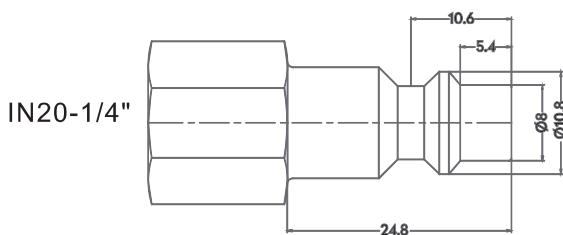

## Compatible with

FOKCA	IN20
INDUSTRIAL	1/4"
PARKER	20
RECTUS	23
HANSEN	3000
CEJN	310
ATLAS COPCO QIC	08

## Features

IK20 series pneumatic quick couplings are a variant of the IN20 series and are compatible with Parker's 20 Industry series nipples or plugs. It is usually made of carbon steel with nickel-plated on the surface or brass with acid pickling, and the internal element is made of brass as well. This series of quick couplings are designed with 4 steel balls, and its maximum working pressure is between IH20 and IM20 series.

If replace its sealing with FKM, it can also work under high temperature conditions. The regular IK20 is designed with a 1/4" flow rate body. If needs a larger flow rate, you are recommended to choose IN30, IN40 series.

## Specification

Series	IK20
Body Size(in.)	1/4"
Rated Pressure(MPa)	2.0MPa
Temperature Range	-10°C ~ +70°C
Locking Device	4 balls

## Performance

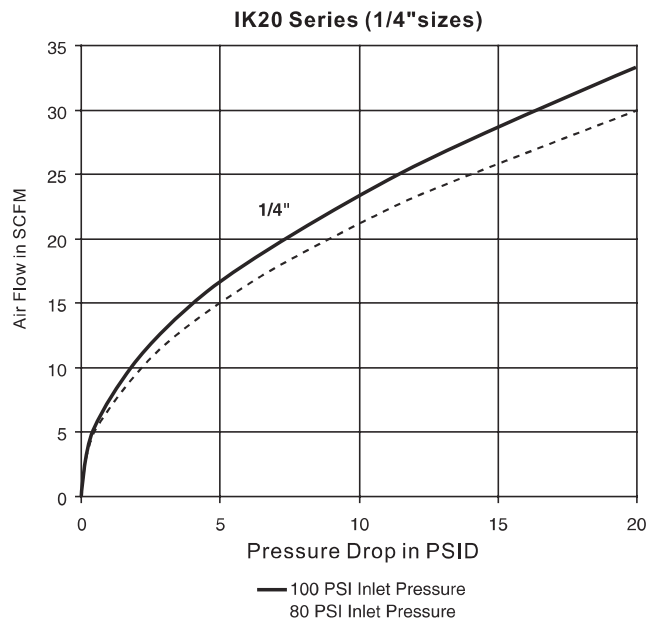

—○>+← Self sealing socket+Thru-type plug

## Sockets/Couplers

### Female Pipe Thread



Model	Body Size	Thread -NPT	Overall (A)	Hex Size (B)	Diameter (D)
IK20-SF-02	1/4	1/4-18	48	19	22.8

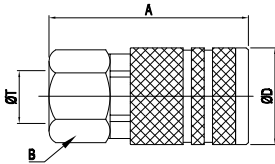

### Male Pipe Thread



Model	Body Size	Thread -NPT	Overall (A)	Hex Size (B)	Diameter (D)
IK20-SF-02	1/4	1/4-18	54	19	22.8

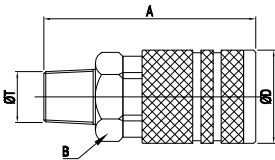

### Standard Hose Barb



Model	Body Size	Hose I.D.	Overall (A)	Exposed (B)	Diameter (D)
IK20-SH-1/4	1/4	1/4	63	19	22.8

