

TC Type bracket for SI cylinder (ISO6431):



1. Ordering Code :

TC - 50 - SI
 ↑ ↑ ↑
 Model Bore of cylinder For SI cylinder only
 TC type bracket

2. Characteristics:

- 1) This series of mount flange matches with SI standard cylinders
- 2) Surface treatment: Paint coating.
- 3) Material of the body: Carbon steel.
- 4) With 4pcs of steel boltst for convenience of installation.

3. Overall and dimension:

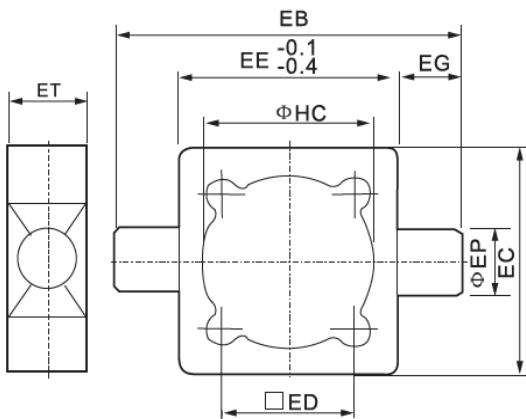

Symbol/Bore	32	40	50	63	80	100
EB	100	113	125	140	160	182
EC	52	63	74	80	105	128
ED	32.5	38	46.5	56.5	72	89
EE	52	63	75	90	105	128
EG	25	25	25	25	25	25
EP	12	16	16	20	20	25
ET	20	22	22	28	28	34
HC	37	45	55	68	87	107.5