

MA Series Stainless Steel Mini Cylinder:



1. Ordering Code :

MA	-	□	20 X	50	-	25	-	S	-	LB
↑		↑	↑	↑		↑		↑		↑
Model		Blank:Fishtail type	Bore size	Stroke		Adjust stroke		S:with magnet		Fixed type
MA: Double action type		CM: Rounded type				0~100mm		Blank:no magnet		Blank: Basic type
MSA: Single spring return type		U:Horizontal type								LB:Foot mounting type
MAD: Two axis double action type										FA:Front flange mounting type
MACD: Two axis double action type with stroke adjustable										SDB: Back cover fixed type
MAJ: Two axis double action type with stroke adjustable										U:Back cover fixed type
MAC: Two axis double action type										

2.Characteristics:

- 1) This series of stainless steel mini cylinder conforms to: Airtac standard
- 3) We can offer different kinds of mounting style according to standard, like Foot mounting, Front flange mounting, Rear-flange mounting, and so on.
- 4) Different thread type can be offered according to customers' requirements, e.g.:BSP , NPT etc.
- 5) Needn't lubricate on piston rod by oil

3.Internal Structure:

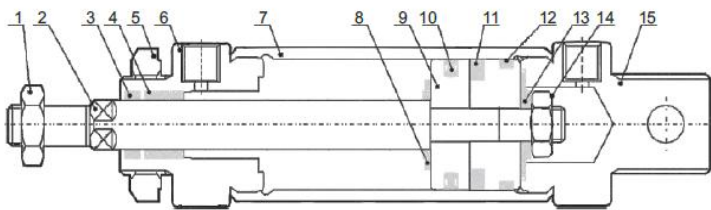

NO.	Designation	NO.	Designation
1	Piston Rod Nut	2	Piston Rod
3	Front Cover Seal Ring	4	Oiled Bearing
5	Front Cover Nut	6	Front Cover
7	Stainless steel tube	8	Anti-crash cushion
9	Piston	10	Piston O-Ring
11	Magnet(Optional)	12	Wear Ring
13	Seal cushion	14	Hex socket screw
15	Back Cover		

4.Specification:

Bore(mm)		16	20	25	32	40
Motion pattern		Double Action or Single Action				
Working Medium		Air				
Fixed Type		Normal Type LB Type FAType SDB Type U Type				
Operating Voltage Range		0.1~0.9MPa				
Ensured Pressure Resistance		1.35MPa				
Operating Temperature Range		-5~70℃				
Operating Speed Range		50~800mm/s				
Buffer Type	Standard Type	Anti-crash cushion				
	Damping Type	Adjustable cushion				
Pipe Size		M5×0.8		G1/8"		

5. Stroke:

Bore(mm)	Standard Stroke												Max.Stroke	Permissible Stroke			
16	25	50	75	80	100	125	160	175	200				300	500			
20	25	50	75	80	100	125	160	175	200	250	300				500	650	
25	25	50	75	80	100	125	160	175	200	250	300	350	400	450	500	500	650
32	25	50	75	80	100	125	160	175	200	250	300	350	400	450	500	500	650
40	25	50	75	80	100	125	160	175	200	250	300	350	400	450	500	500	650

6. Overall and Dimension Sheet:

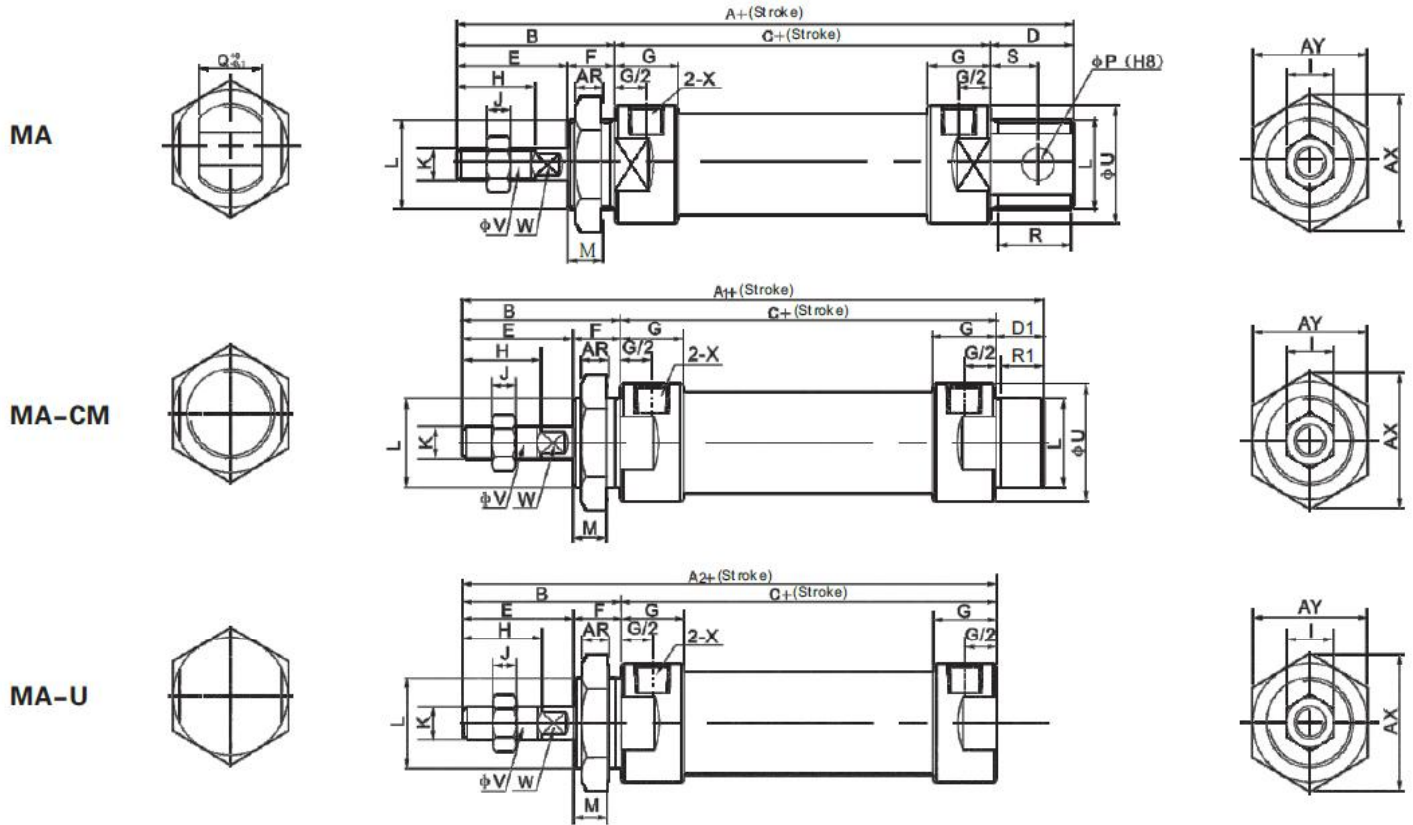

Bore/Symbol	A	A1	A2	B	C	D	D1	E	F	G	H	I	J	K
16	114	114	98	38	60	16	16	22	16	10	16	10	5	M6×1
20	137	128	116	40	76	21	12	28	12	16	20	12	6	M8×1.25
25	141	134	120	44	76	21	14	30	14	16	22	17	6	M10×1.25
32	147	134	120	44	76	27	14	30	14	16	22	17	6	M10×1.25
40	149	136	122	46	76	27	14	32	14	16.7	24	17	7	M12×1.25

Bore/Symbol	L	M	P	Q	R	R1	S	U	V	W	X	AR	AX	AY
16	M16×1.5	14	6	12	14	14	9	21	6	5	M5	6	24	27.5
20	M22×1.5	10	8	16	19	10	12	27	8	6	G1/8"	7	33	29
25	M22×1.5	12	8	16	19	12	12	30	10	8	G1/8"	7	33	29
32	M24×2.0	12	10	16	25	12	15	35	12	10	G1/8"	8	37	32
40	M30×2.0	12	12	20	25	12	15	41.6	16	14	G1/8"	9	47	41

MSA:

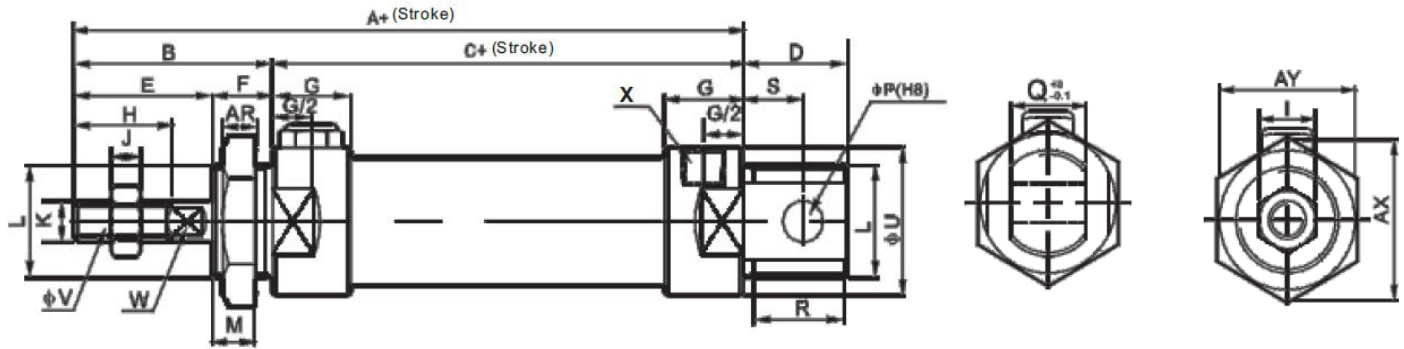

MSA-CM:

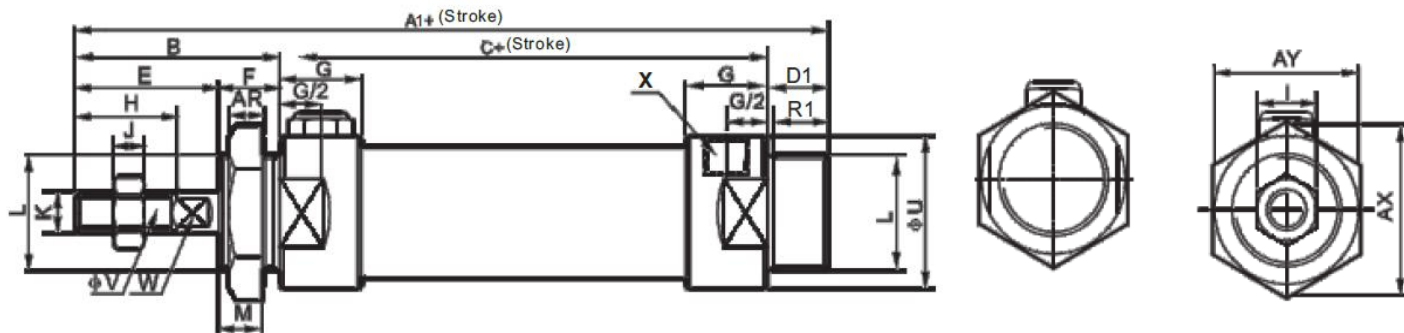

MSA-U:

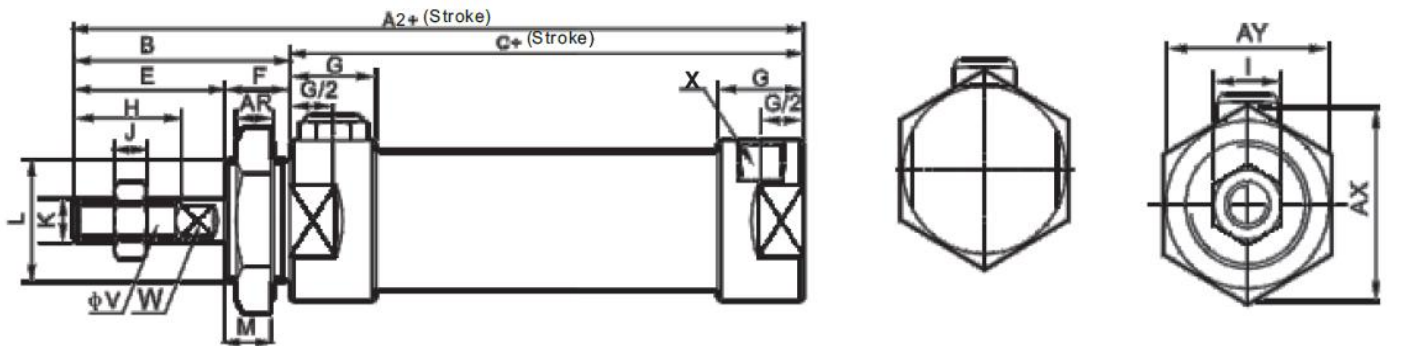

Symbol	A		A1		A2		B	C		D	D1	E	F	G	H	I	J
	0-50	51-100	0-50	51-100	0-50	51-100		0-50	51-100								
16	114	139	128	153	98	123	38	60	85	16	16	22	16	10	16	10	5
20	137	162	134	159	116	141	40	76	101	21	12	28	12	16	20	12	6
25	141	166	134	159	120	145	44	76	101	21	14	30	14	16	22	17	6
32	147	172	136	161	120	145	44	76	101	27	14	30	14	16	22	17	6
40	149	174	122	144	122	147	46	76	101	27	14	32	14	22	24	17	7

Inside Diameter/Symbol	K	L	M	P	Q	R	R1	S	U	V	W	X	AR	AX	AY
16	M6×1	M16×1.5	14	6	12	14	14	9	21	6	5	M5	6	25	22
20	M8×1.25	M22×1.5	10	8	16	19	10	12	27	8	6	G1/8"	7	33	29
25	M10×1.25	M22×1.5	12	8	16	19	12	12	30	10	8	G1/8"	7	33	29
32	M10×1.25	M24×2.0	12	10	16	25	12	15	35	12	10	G1/8"	8	37	32
40	M12×1.25	M30×2.0	12	12	20	25	12	15	41.6	16	14	G1/8"	9	47	41

MAD:

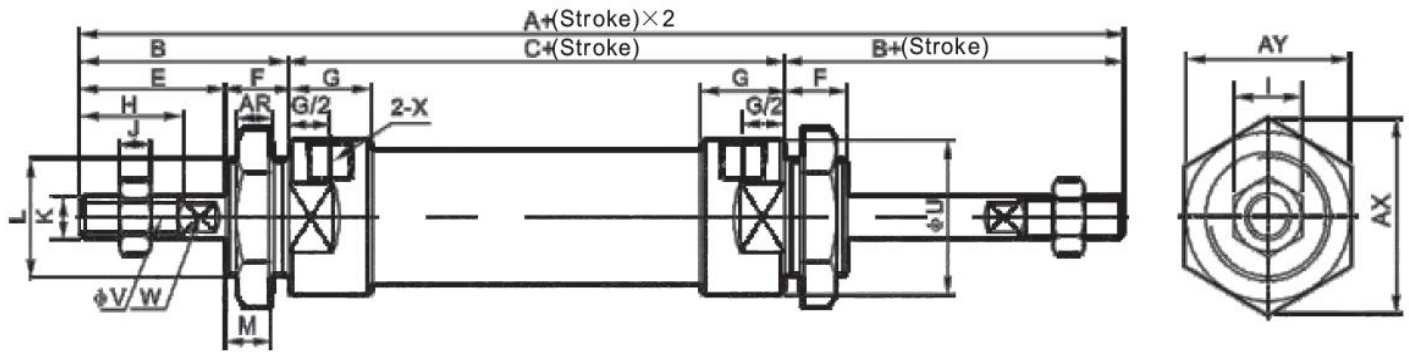

MAJ:

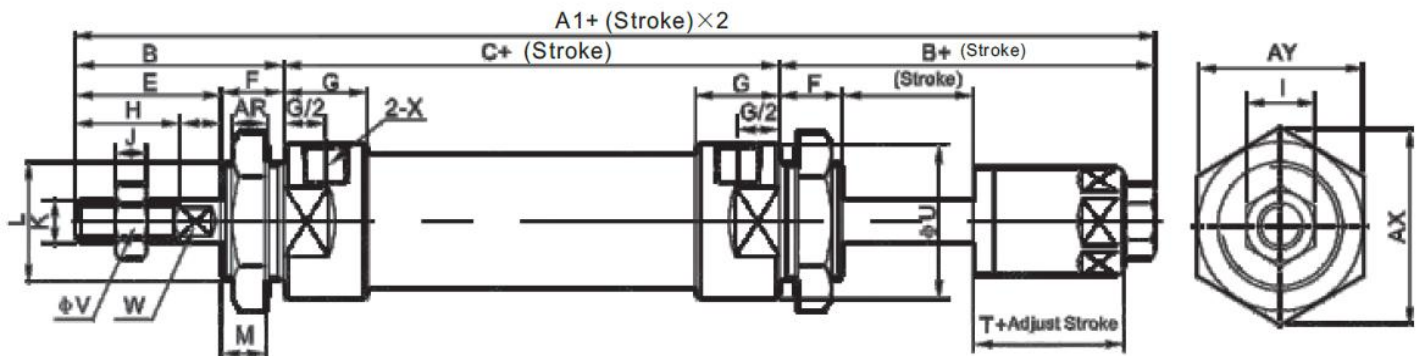

Inside Diameter/Symbol	A	A1	B	C	E	F	G	H	I	J	K
16	136	135	38	60	22	16	10	16	10	5	M6×1
20	156	153	40	70	28	12	16	20	12	6	M8×1.25
25	164	161	44	70	30	14	16	22	17	6	M10×1.25
32	164	161	44	70	30	14	16	22	17	6	M10×1.25
40	168	164	46	92	32	14	22	14	17	7	M12×1.25

Inside Diameter/Symbol	L	M	U	V	W	X	AR	AX	AY	T
16	M16×1.5	14	21	6	5	M5	6	25	22	16
20	M22×1.5	10	29	9	6	G1/8"	7	33	29	19
25	M22×1.5	12	34	10	8	G1/8"	7	33	29	21
32	M24×2.0	12	39.5	12	10	G1/8"	8	37	32	21
40	M30×2.0	12	49.5	16	12	G1/8"	9	47	41	21