

# DSN Series ISO6432 Stainless Steel Mini Cylinder:



## 1. Ordering Code :

DSN	-	□	20 X	50	-	25	-	S	-	LB
↑		↑	↑	↑		↑		↑		↑
Model		Blank: Fishtail type	Bore size	Stroke		Adjust stroke 0~100mm		S: with magnet Blank: no magnet		Fixed type Blank: Basic type LB: Foot mounting type FA: Front flange mounting type SDB: Back cover fixed type U: Back cover fixed type

DSN: Double action type      CM: Rounded type  
 ESN: Single acting spring return      U: Horizontal type  
 DSND: Two axis double action type  
 DSNJ: Two axis double action type with stroke adjustable

## 2. Characteristics:

- 1) This series of stainless steel mini cylinder conforms to: ISO6432 standard
- 3) We can offer different kinds of mounting style according to standard, like Foot mounting, Front flange mounting, Rear-flange mounting, and so on.
- 4) Different thread type can be offered according to customers' requirements, e.g.: BSP, NPT etc.
- 5) Needn't lubricate on piston rod by oil

## 3. Internal Structure:

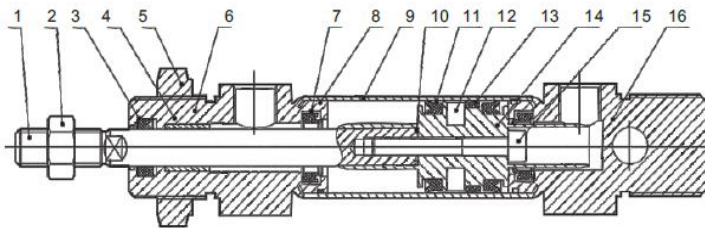

NO.	Designation	NO.	Designation
1	Piston Rod	9	Barrel
2	Piston Rod Nut	10	Piston rod O-ring
3	Front Cover Seal	11	Piston O-ring
4	Bearing	12	Magnet(Optional)
5	Hexagon Screw	13	Wear Ring
6	Front Cover	14	Piston
7	Cushion Ring	15	Hex Socket Screw
8	O-ring	16	Back Cover

## 4. Specification:

Cylinder diameter(mm)	8	10	12	16	20	25
Working Medium	/Air					
Motion pattern	/Double Action or single Action					
Ensured Pressure Resistance	15.3kgf/cm <sup>2</sup> (1.5Mpa)					
Max.pressure	10.2kgf/cm <sup>2</sup> (1.0Mpa)					
Min.pressure	0.5kgf/cm <sup>2</sup> (0.05Mpa) 1kgf/cm <sup>2</sup> (0.1Mpa)					
Environment and fluid temp	-20~+80℃( Internal Magnetic Install by Tach strap:Type Max:60℃)					
Piston velocity	Rubber Bufer(Standard),			Air Buffer(Optional)		
Buffering	50~750mm/s					
Kinetic energy To Lerance(kgf/cm)	0.2	0.3	0.4	0.9	2.7	4
Pipe Size	M5×0.8				G1/8"	

## 5. Stroke:

Bore(mm)	Standard stroke	Max.Stroke(mm)
8	10,25,40,50,80,100,125,160,200	400
10	10,25,40,50,80,100,125,160,200	400
12	10,25,40,50,80,100,125,160,200	400
16	10,25,40,50,80,100,125,160,200	400
20	25,40,50,80,100,125,150,160,175,200,250,300	1000
25	25,40,50,80,100,125,150,160,175,200,250,300	1000

Note: In non-standard stroke options.

## 6. Overall and Dimension Sheet:

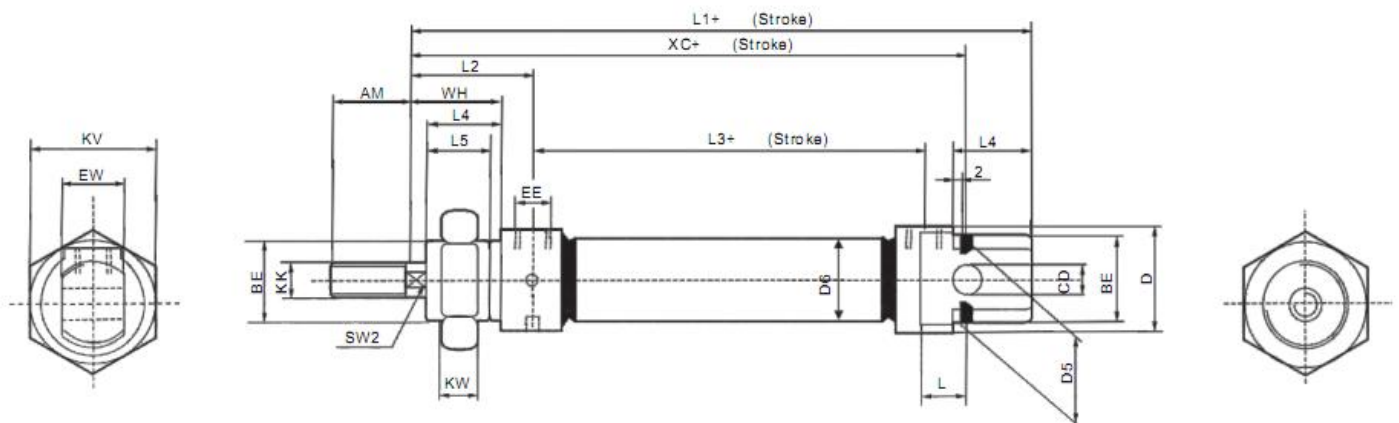

Bore/Symbol	AM	BE	ΦCD	ΦD	ΦD5	ΦD6	EE	EW	AM	KK	KV	KW	L	L1	L2	L3	L4	L5	SW2	WH	XC
8	12	M12×1.25	4	15	15	12	M5	8	12	M4	19	7	6	78	22	34	12	10	-	16	64
10	12	M12×1.25	4	15	15	12	M5	8	12	M4	19	7	6	78	22	34	12	10	-	16	64
12	16	M16×1.5	6	20	20	16	M5	12	16	M6	24	6	9	89	28	38	17	15	5	22	75
16	16	M16×1.5	6	20	20	16	M5	12	16	M6	24	6	9	95	28	44	17	15	5	22	82
20	20	M22×1.5	8	27	27	22	G1/8"	16	20	M8	30	8	12	112	32	51.6	20	18	7	24	95
25	22	M22×1.5	8	27	27	22	G1/8"	16	22	M10×1.25	30	8	12	119.5	36	53.1	22	20	8	26	104